

**MAP INFORMATION:**  
BASE MAP INFORMATION OBTAINED FROM TAX PARCEL NO. 182.06-1-58, VILLAGE OF TANNERSVILLE, GREENE COUNTY, NEW YORK. SURVEY PRODUCED BY CATSKILL REGION SURVEYING SERVICES, P.C. ON MAY 24, 2017.

**DIG SAFE NOTE:**  
THIS PLAN SET WAS DRAFTED WITHOUT THE BENEFIT OF "DIG SAFE" MARKINGS. UTILITIES SHOWN ARE NOT WARRANTED TO BE EXACT OR COMPLETE. THE CONTRACTOR SHALL CONTACT "DIG SAFE" AT 811 BEFORE COMMENCING ANY WORK AND SHALL PRESERVE EXISTING UTILITIES WHICH ARE NOT SPECIFIED TO BE REMOVED IN THIS PLAN SET.

**REVISIONS**

DATE	DESCRIPTION

IT IS A VIOLATION OF NEW YORK STATE EDUCATION LAW FOR ANY PERSON, UNLESS THEY ARE ACTING UNDER THE DIRECTION OF A LICENSED PROFESSIONAL ENGINEER, ARCHITECT, LANDSCAPE ARCHITECT, OR LAND SURVEYOR, TO ALTER ANY ITEM IN ANY WAY, IF AN ITEM BEARING THE STAMP OF A LICENSED PROFESSIONAL IS ALTERED, THE ALTERING LICENSED PROFESSIONAL SHALL STAMP THE DOCUMENT AND INCLUDE THE NOTATION "ALTERED BY" FOLLOWED BY THEIR SIGNATURE, THE DATE OF SUCH ALTERATION, AND SPECIFIC DESCRIPTION OF THE ALTERATION.

**DRAWINGS NOT FOR CONSTRUCTION**

PREPARED FOR  
**VILLAGE OF TANNERSVILLE**

PROJECT  
**RIP VAN WINKLE LAKE PARK**

DRAWING TITLE  
**PLANTING & LAYOUT PLAN**

PROJECT NO. 24004  
DATE: 01/25/2025  
DWG 1 OF 1

DRAWING NO. **C-4.10**

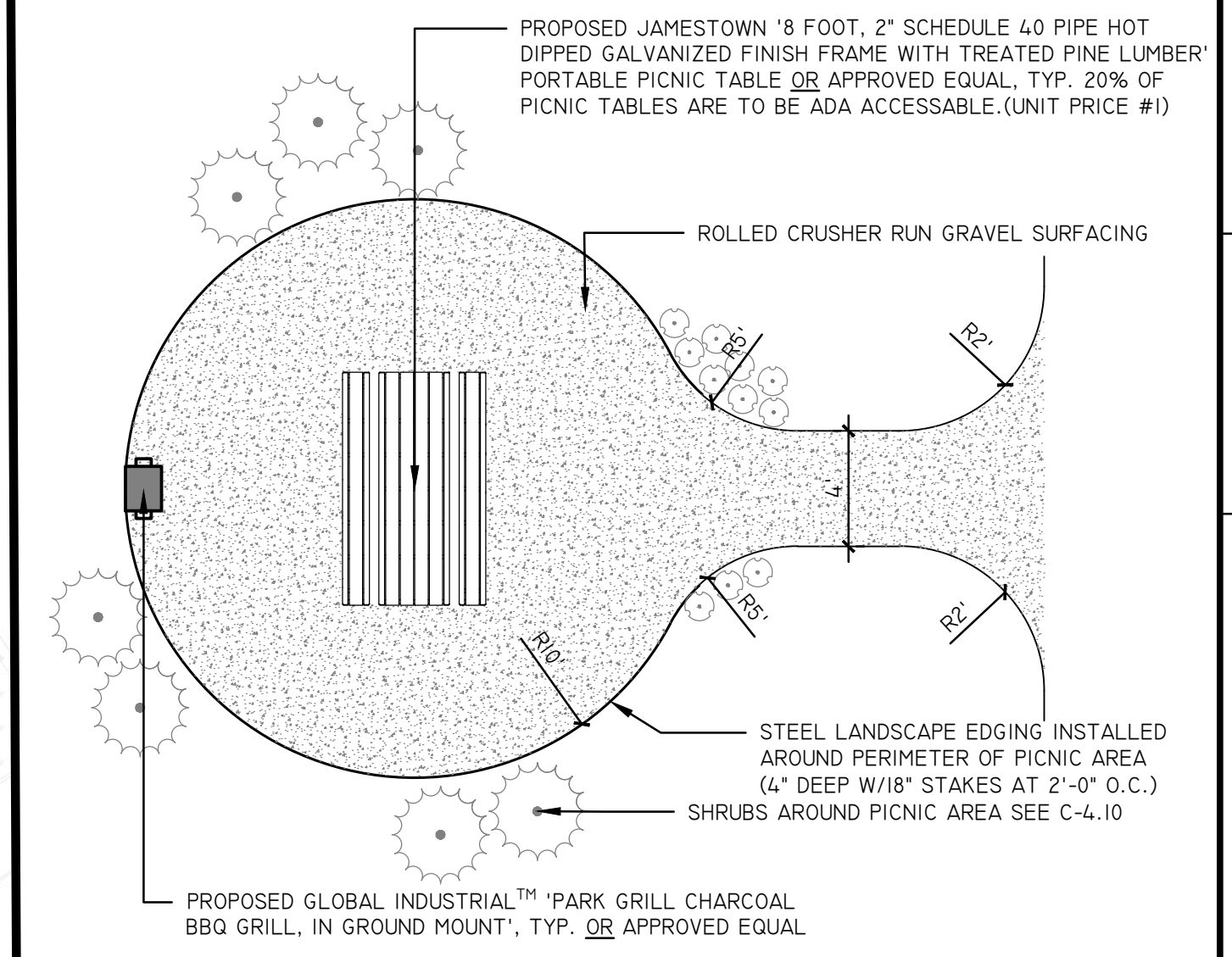

**4 TYPICAL LAKESIDE PICNIC AREA DETAIL**  
SCALE: 3/16"=1'-0"

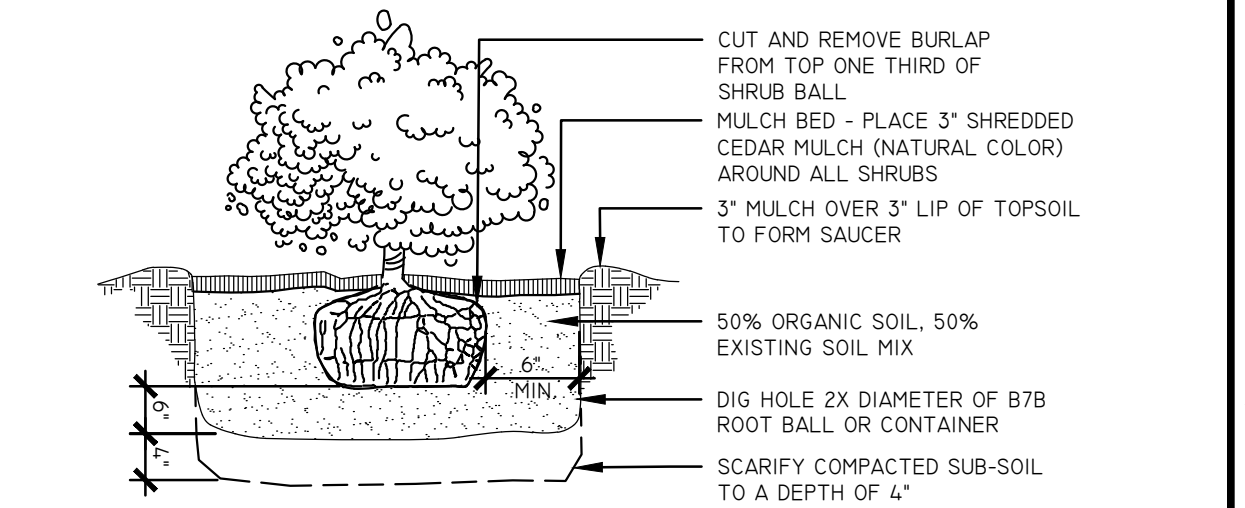

**3 BALLED & BURLAPPED (B&B) DETAIL**  
SCALE: N.T.S.

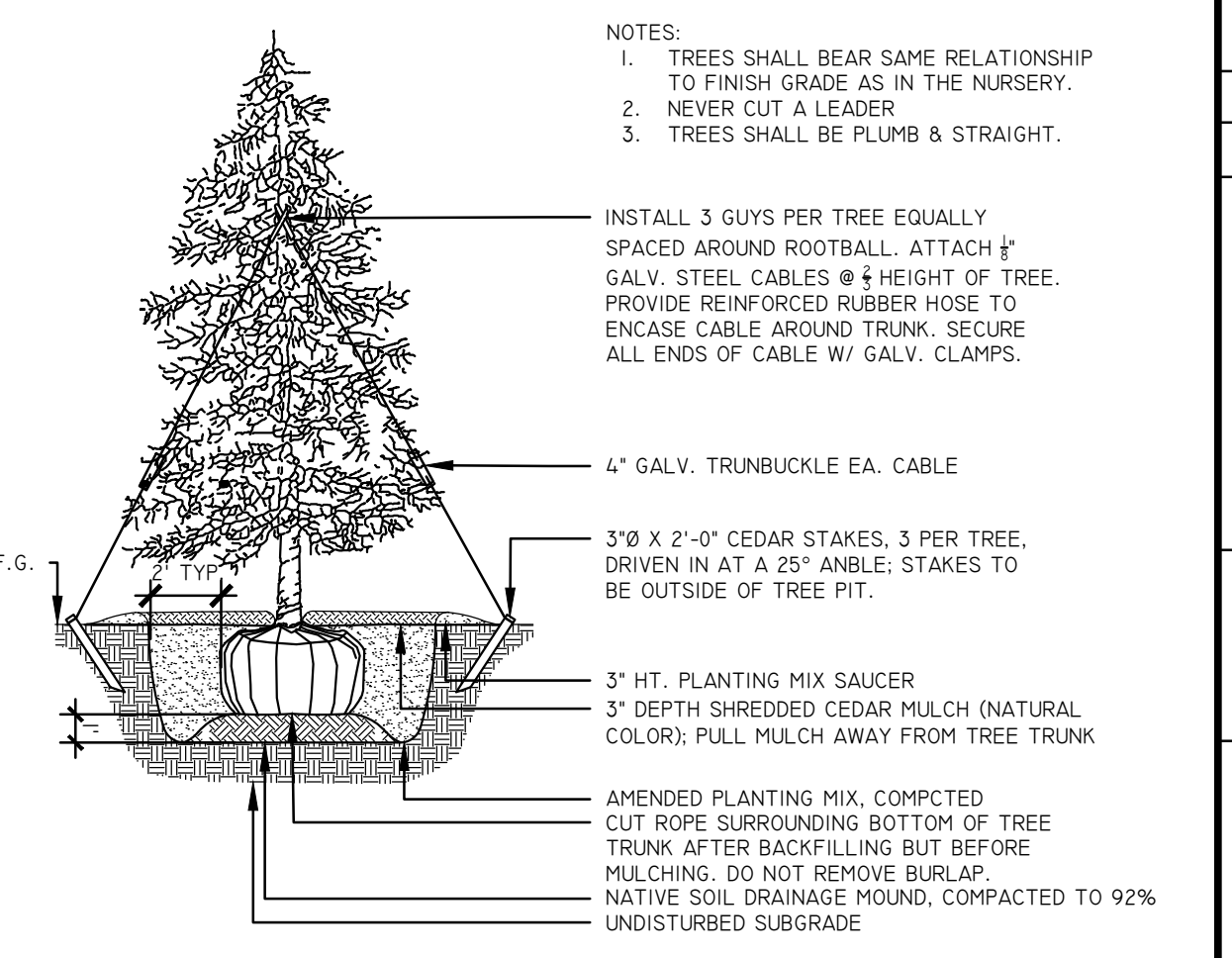

**2 EVERGREEN TREE PLANTING DETAIL**  
SCALE: N.T.S.

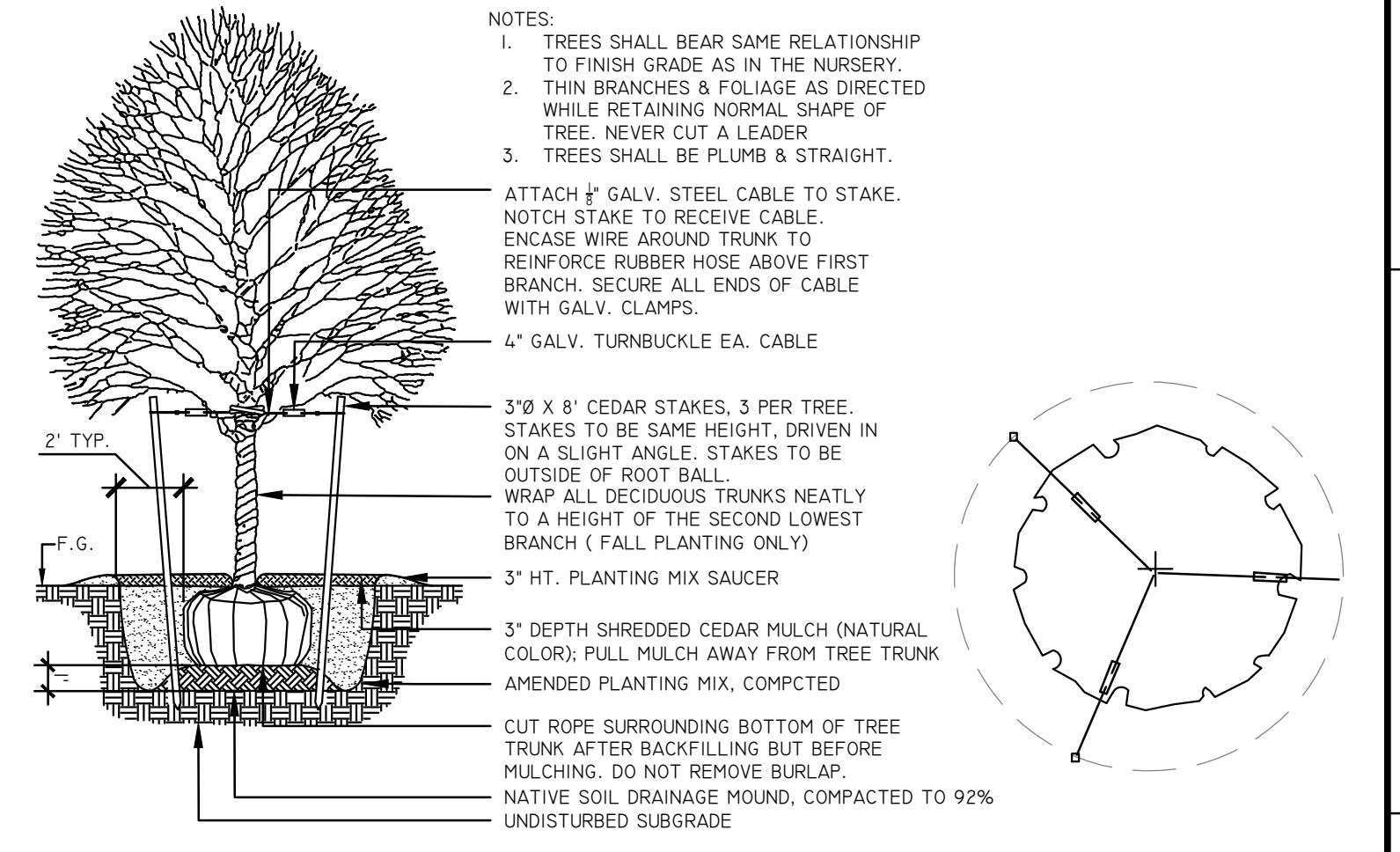

**1 DECIDUOUS TREE PLANTING DETAIL**  
SCALE: N.T.S.

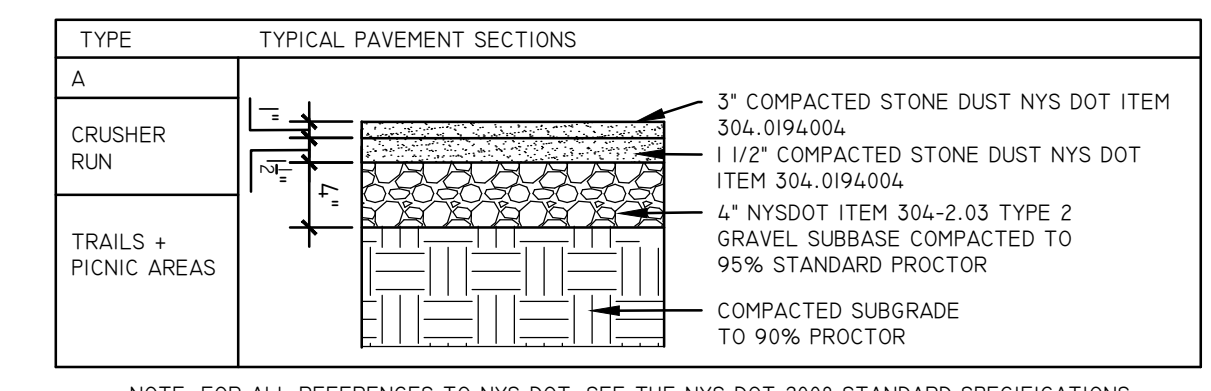

**5 ROLLED CRUSHER RUN**  
SCALE: N.T.S.

**PLANTING SCHEDULE**

KEY	QTY	SYMBOL	SCIENTIFIC NAME	COMMON NAME	SIZE	COMMENTS
<b>TREES</b>						
AR	5	(+)	ACER RUBRUM	RED MAPLE	1 1/2 - 2" CAL.	B&B
BN	4	(*)	BETULA NIGRA 'HERITAGE'	HERITAGE RIVER BIRCH	10-12' HT.	MULTI-STEMMED. 3-5 MAIN STEMS
CC	2	(*)	CERCIS CANADENSIS	AMERICAN REDBUD	10-12' HEIGHT	SINGLE OR MULTI-STEMMED
QA	3	(+)	QUERCUS ALBA	WHITE OAK	1 1/2 - 2" CAL.	B&B
<b>SHRUBS</b>						
MP	38	(*)	MYRICA PENNSYLVANICA	NORTHERN BAYBERRY	3 GAL. CONT.	36" O.C.

